

NHS Grampian - Baird Family Hospital

Notice of Introduction of new One Way Road System

One-Way Road System - Royal Aberdeen Children's Hospital (RACH)

From Wednesday, 6 November 2024*

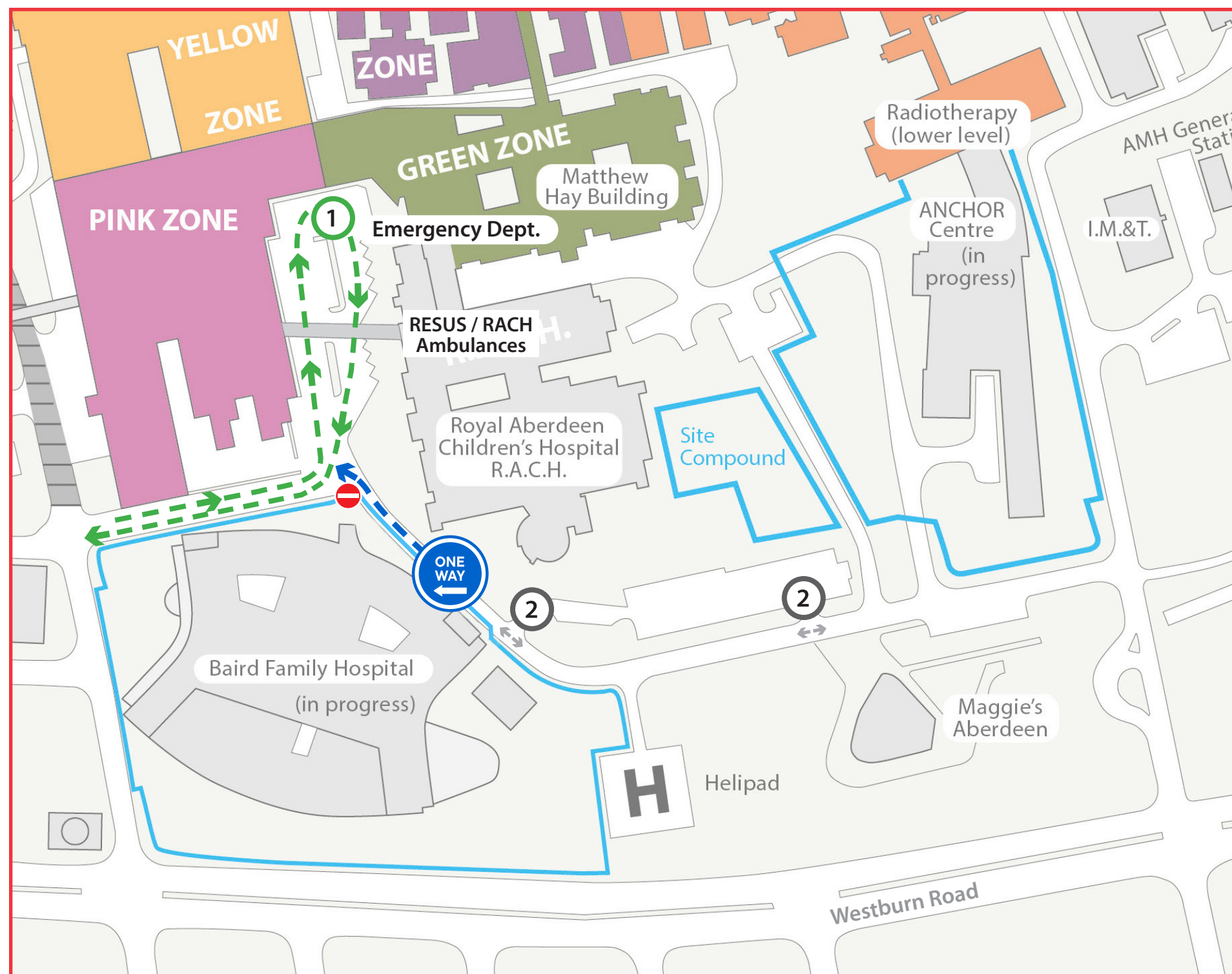

Due to the completion of essential works we are able to reinstate a one-way system outside Royal Aberdeen Children's Hospital (RACH) and The Baird Family Hospital from Wednesday 6 November.

Please be aware, the direction of travel has been changed (now northbound only) to what was previously in place.

This change will now enable all vehicles to:

- 1 Access the Emergency Department (ED/A&E) from Cornhill Road, Westburn Road or from Foresterhill Road.
- 2 Exit from the RACH car park either towards Maggie's/ Westburn Road exit or alternatively towards Foresterhill Road.

The change will block vehicles wishing to travel from Foresterhill Road to the front of RACH and beyond. There will be no through access.

Please follow local signage.

We apologise for any inconvenience caused while construction work is ongoing.

* Date and times are subject to work progressing as planned.